

NOTE:
 1. ALL DIMENSIONS ARE IN mm.
 2. PROVIDE CLEAN COVER OF 50mm FOR FOUNDATION.
 3. PROVIDE 1:1.5.
 4. FOUNDATION DEPTH GIVEN IS TENTATIVE AND SHALL BE VARIED ACCORDING TO THE SITE CONDITION. IN ANY LOOSE SOIL, SET. THE SAME SHALL BE REMOVED AND FILL WITH GOOD GRAIN. 5. FASE CENTERING TO BE PROVIDED IN PRINCIPAL'S ROOM. VICE PRINCIPAL'S ROOM. AND LIBRARY.

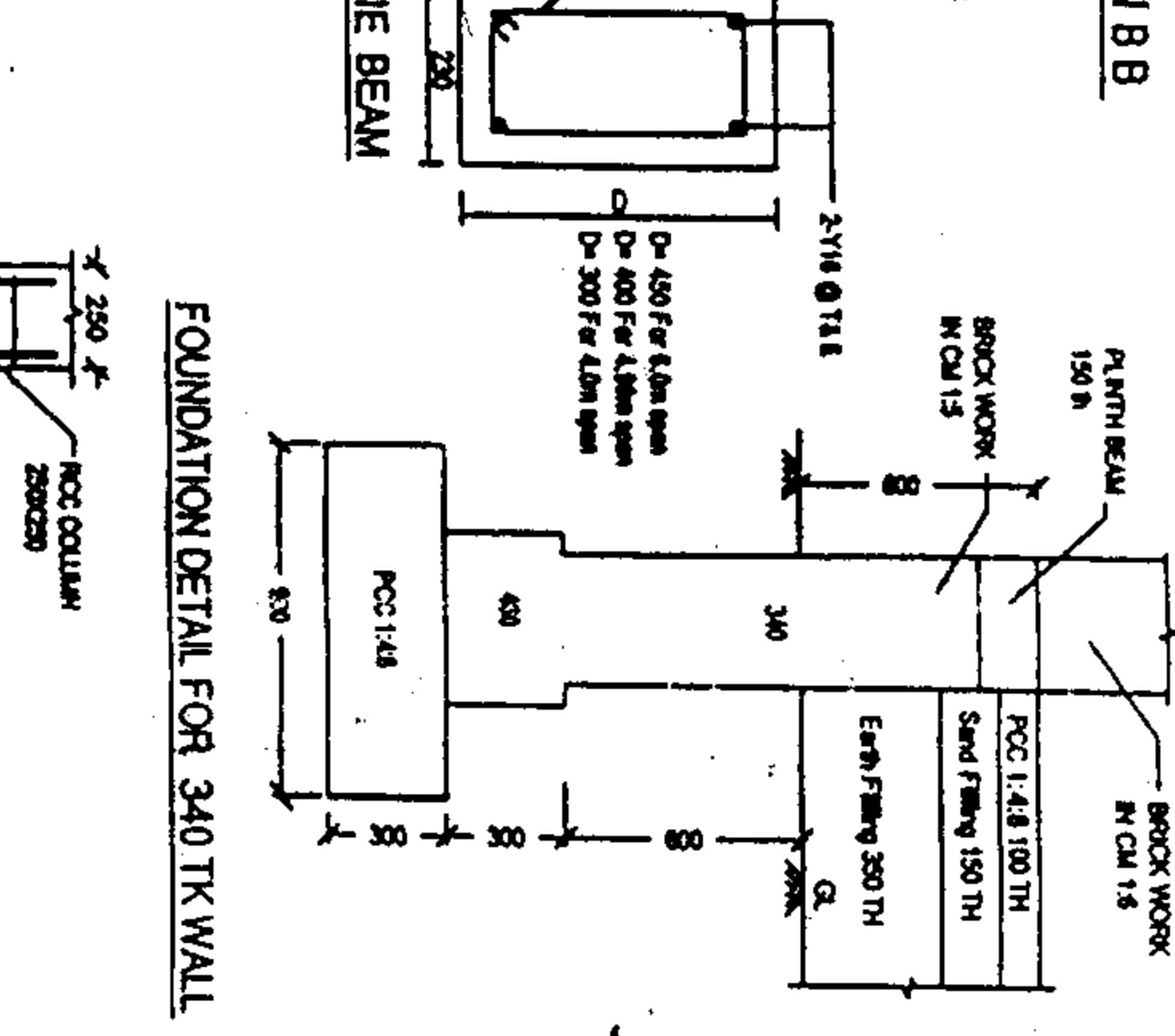
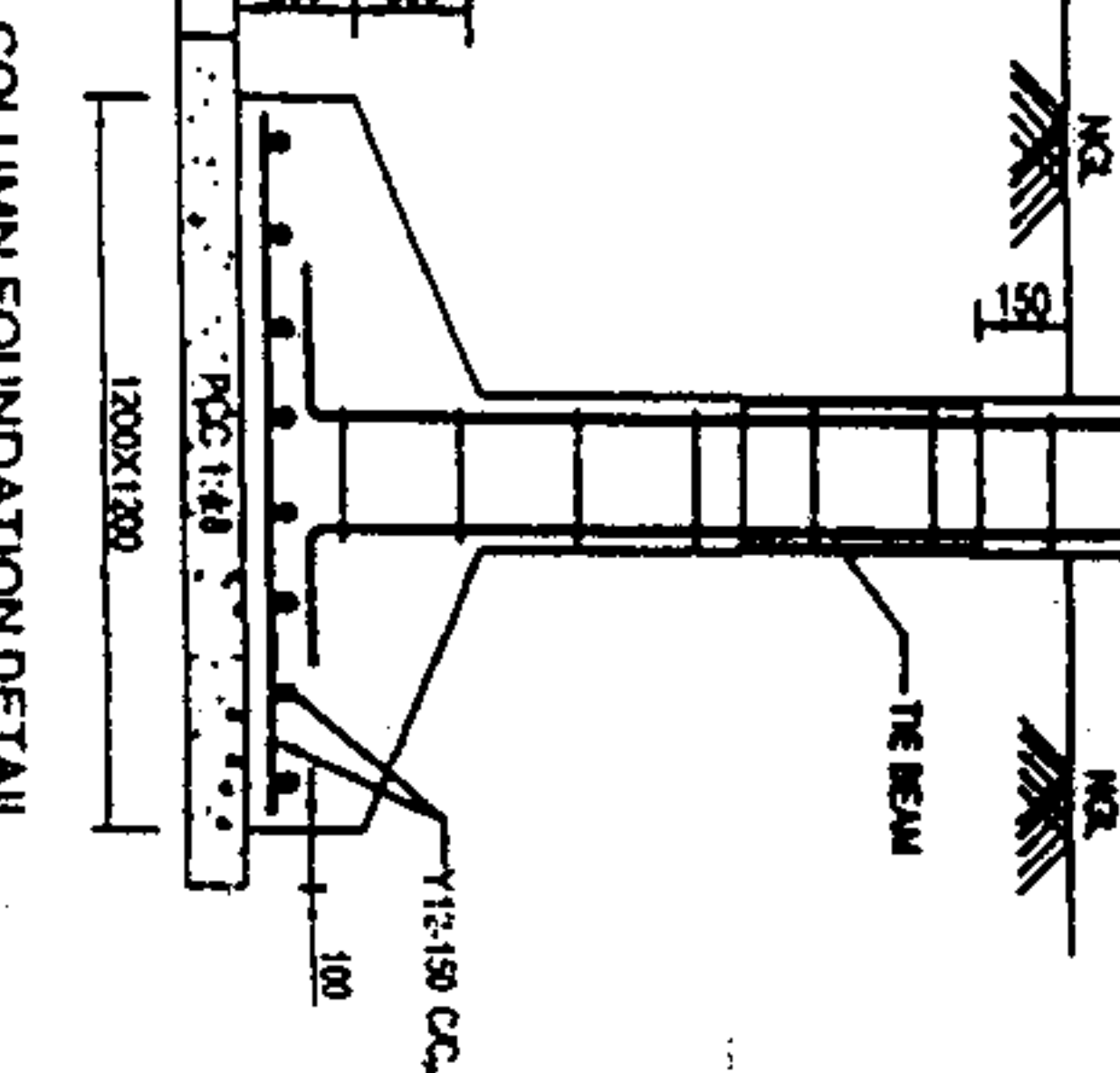

SCHEDULE OF JOINERY

AD	MAIN DOORS WITH ALUMINIUM FRAME AND GLAZED SHUTTERS WITH 450 GLAZED HEAD PANELS FIXED AND MIDDLE PANELS (OPT. MABLE)	XXXXXX400
AD	DOORS WITH ALUMINIUM FRAME AND GLAZED SHUTTERS WITH 450 GLAZED HEAD	XXXXXX400

D1	TW 1/4 FLUSH DOOR	1200X2100	WT	ALUMINIUM GLAZED WINDOW	1500X1350
D2	TW 5/8 FLUSH DOOR	1000X1100	W2	ALUMINIUM GLAZED WINDOW	1000X1350
D3	TW 5/8 FLUSH DOOR	900X1100	V	ALUMINIUM GLAZED VENTILATOR	500X800
D4	P.V.C. DOOR	800X2000	SC	STRUCTURAL ALUMINIUM	1500X2400

DATE	19/11/2011	SIGNATURE	[Signature]
DATE	10/11/2011	SIGNATURE	[Signature]
DATE	10/11/2011	SIGNATURE	[Signature]
DATE	10/11/2011	SIGNATURE	[Signature]

INDUSTRIAL TRAINING CENTRE
 BARSINGAR
 ADMINISTRATIVE BLOCK

Plan, Sections & Foundation Details
 Scale: 1:100 (P), 1:50 (S)

DRG. NO. CCMC/05/2011

10/11/2011

PROJECT: BARSINGAR AS ON 11/2011

NEVELL LIGHTS CORPORATION LTD.
 A. GOVT. OF KERALA ENTERPRISES
 NEVELL, 607/01, TAMMIL NAGU

OFFICE OF THE GENERAL MANAGER / CIVIL / CTO